

## Class 150 (Standard) Fig. 3101 90° Elbow



For Listings/Approval Details and Limitations, visit our website at [www.asc-es.com](http://www.asc-es.com) or contact an ASC Engineered Solutions™ Sales Representative.

**Figure 3101** 90° Elbow

Nominal Size	Dimension A	Approx Wt. Each
In. (mm)	In. (mm)	Lbs. (kg)
1/8	0.69	0.06
6	17.53	0.03
1/4	0.81	0.10
8	20.57	0.05
3/8	0.95	0.15
10	24.13	0.07
1/2	1.12	0.22
15	28.45	0.10
3/4	1.31	0.36
20	33.27	0.16
1	1.50	0.57
25	38.10	0.26
1 1/4	1.75	0.87
32	44.45	0.40
1 1/2	1.94	1.16
40	49.28	0.53
2	2.25	1.81
50	57.15	0.82
2 1/2	2.70	3.23
65	68.58	1.47
3	3.08	4.82
80	78.23	2.19
4	3.79	8.41
100	96.27	3.82
6	5.13	19.96
150	130.30	9.05

### Material Specifications

#### Dimensions:

Fittings: ASME B16.3

Unions: ASME B16.39

Bushings/Plugs: ASME B16.14

**Material:** ASTM A-197

**Finish:** Black or Hot Dip Galvanized per ASTM A153 Class A

**Threads\*:** NPT per ASME B1.20.1

#### Pressure Ratings:

Fittings: ASME B16.3

Unions: ASME B16.39

Bushings/Plugs: ASME B16.14

**Pressure Testing:** All malleable iron fittings are tested for through wall porosity using an air under water process.

**Agency Approvals:** All malleable iron fittings and unions are UL/ULC Listed and FM Approved.

\*British Standard threading per BS 21 available upon request.

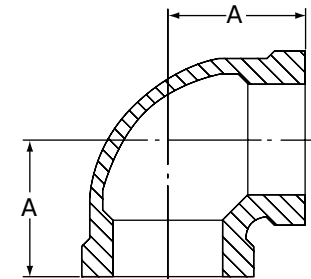

PROJECT INFORMATION	APPROVAL STAMP
Project:	Approved
Address:	Approved as noted
Contractor:	Not approved
Engineer:	Remarks:
Submittal Date:	
Notes 1:	
Notes 2:	