

## Class 300 (XS/XH) Fig. 3163 Cap



For Listings/Approval Details and Limitations, visit our website at [www.asc-es.com](http://www.asc-es.com) or contact an ASC Engineered Solutions® Sales Representative.

**Figure 3163** Cap

Nominal Size		Dimension A	Approx Wt. Each	
In. (mm)		In. (mm)	Lbs. (kg)	
1/4	8	0.78	0.10	0.05
3/8	10	0.81	0.15	0.07
1/2	15	1.00	0.23	0.10
3/4	20	1.06	0.35	0.16
1	25	1.25	0.58	0.26
1 1/4	32	1.38	0.94	0.43
1 1/2	40	1.44	1.20	0.54
2	50	1.69	1.90	0.86
2 1/2	65	2.06	3.30	1.50
3	80	2.19	4.70	2.13

### Material Specifications

#### Dimensions:

Fittings: ASME B16.3

Unions: ASME B16.39

Bushings/Plugs: ASME B16.14

**Material:** ASTM A-197

**Finish:** Black or Hot Dip Galvanized per ASTM A153 Class A

**Threads:** NPT per ASME B1.20.1

#### Pressure Ratings:

Fittings: ASME B16.3

Unions: ASME B16.39

Bushings/Plugs: ASME B16.14

**Pressure Testing:** All malleable iron fittings are tested for through wall porosity using an air under water process.

**Agency Approvals:** All malleable iron fittings and unions are UL/ULC Listed and FM Approved.

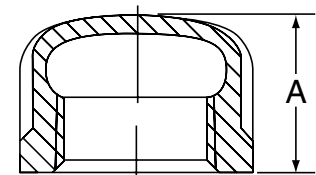

PROJECT INFORMATION	APPROVAL STAMP
Project:	Approved
Address:	Approved as noted
Contractor:	Not approved
Engineer:	Remarks:
Submittal Date:	
Notes 1:	
Notes 2:	