

Class 125 (Standard) Fig. 3351 90° Elbow



For Listings / Approval Details and Limitations, visit our website at www.asc-es.com or contact an ASC Engineered Solutions™ Sales Representative.

Material Specifications

Dimensions: ASME B16.4 Class 125

Material: ASTM A126

Finish: Black or Hot Dip Galvanized per ASTM A153 Class A

Threads: NPT per ASME B1.20.1

Agency Approvals: Fig 3351 90° Elbow sizes 1/2" - 2" are UL/ULC Listed and FM Approved.

Figure 3351 90° Elbow

Nominal Size		Maximum Working Pressure ▲	Dimension A	Approx Wt. Each
In. (mm)		psi (kPa)	In. (mm)	Lbs. (kg)
1/2"		300	1.12	0.36
13		2065	28.45	0.16
3/4"		300	1.31	0.59
19		2065	33.27	0.27
1		300	1.50	0.84
25		2065	38.10	0.38
1 1/4		300	1.75	1.34
32		2065	44.45	0.61
1 1/2		300	1.94	1.80
40		2065	49.27	0.82
2		300	2.25	2.90
50		2065	57.15	1.32
2 1/2		300	2.70	4.75
65		2065	68.58	2.15

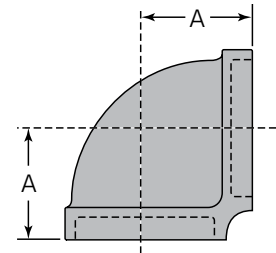

▲ - Working Pressure Ratings are for reference only and based on Sch. 40 pipe. For the latest UL/ULC, and FM pressure ratings versus pipe schedule, please visit asc-es.com or contact your local ASC Engineered Solutions™ Representative.

PROJECT INFORMATION	APPROVAL STAMP
Project:	Approved
Address:	Approved as noted
Contractor:	Not approved
Engineer:	Remarks:
Submittal Date:	
Notes 1:	
Notes 2:	