

Riser Clamp – Standard Fig. 40

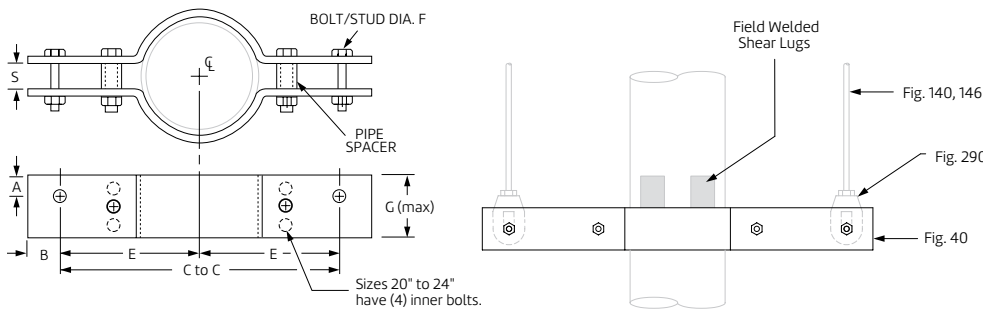
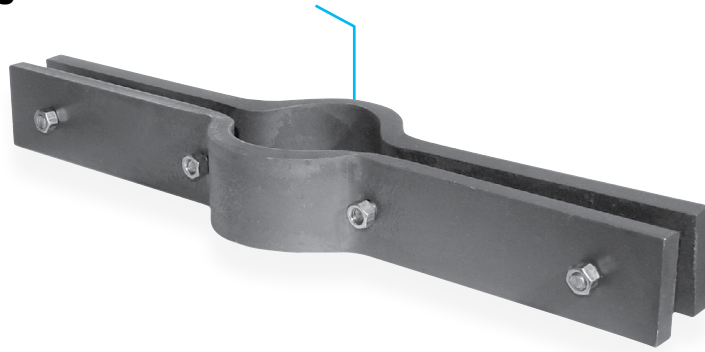

Size Range: 2" through 24"

Material: Carbon steel (CS), Alloy (A), or Stainless Steel (SS)

Finish: Plain or Hot-Dip Galvanized with Zinc Plated Fasteners

Maximum Temperature: Galvanized 450° F, 650° F (CS), 950° F (A) and 1,000° F (SS)

Service: Riser clamps are used for the support of vertical piping. Load is carried by shear lugs which are welded to the pipe. Shear lugs provided upon request. Local pipe wall stress evaluation available upon request.

Approvals: Complies with Federal Specification A-A-1192A (Type 42), ANSI/MSS SP-69 and MSS SP-58 (Type 42).

Ordering: Specify pipe size, material, figure number, name and finish.

Note: If different loads or dimensions are required, refer to Fig. 40 SD special design riser clamp.

Fig. 40: Dimensions (in) Loads (lbs) • Weight (lbs)

Pipe Size	Max Load		C-C	E	F (max)	G (max)	S	A (CS)	A (alloy) (SS)	B (max)	Maximum Weight Each		
	Rigid Assembly	Spring Assembly									CS	SS	Alloy
2	900	1,800	18	9	3/8	2 1/2		1/4	7/8		18	15	18
2 1/2			20	10							20	20	20
3	1,500	3,000	20	10	1/2	3	3/4	1 1/2			30	25	30
4	2,200	4,400	22	11							40	40	44
5			24	12	4	2	1 1/8	2	45	40	45		
6	3,000	6,000	24	12	5/8	5	1	7/8	1 1/4		60	60	73
8			27	13 1/2							82	82	82
10	5,500	11,000	30	15	7/8	6	1 1/2	1 1/4	1 5/8	2 1/2	157	157	157
12	7,800	15,600	32	16	1	7	1 3/4	1 3/8	1 7/8		216	202	250
14			34	17	1 3/8	1 3/8	228	228	263				
16	9,000	18,000	36	18	1 1/8	6	2	1 1/2	2		314	277	315
18			39	19 1/2							7	2	338
20	13,500	27,000	42	21	2	10	2 1/2	2 5/8	2 5/8	4 1/4	525	525	580
24			45	22 1/2							11	621	565

PROJECT INFORMATION	APPROVAL STAMP
Project:	Approved
Address:	Approved as noted
Contractor:	Not approved
Engineer:	Remarks:
Submittal Date:	
Notes 1:	
Notes 2:	