

**Fig. 7061P** Reducing Tee

**Fig. 7084P** Flange Nipples (Plain-End x Class 150)

**Fig. 7085P** Flange Nipples (Plain-End x Class 300)

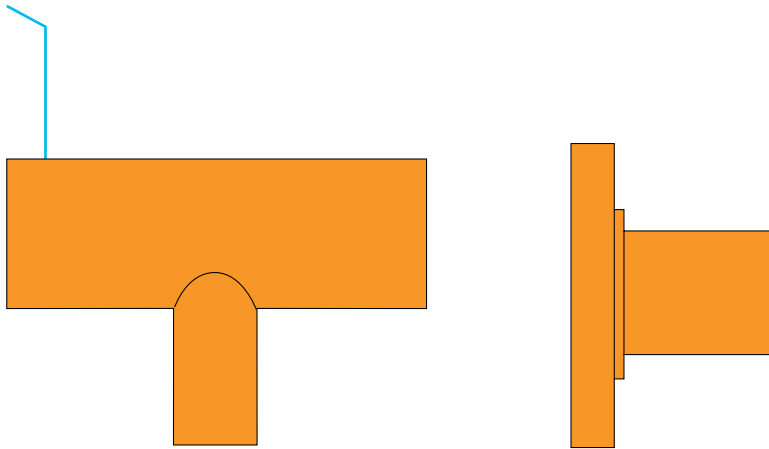

Fig. 7061P

Fig. 7084P & 7085P

Gruvlok plain-end fittings are manufactured to provide minimum pressure drop and uniform flow. Fittings are designed for use with the Fig. 7005 Roughneck Couplings only.

Gruvlok plain-end fittings are available in sizes through 8" nominal pipe size in a variety of styles. Depending on size and configuration, fittings are either segment-welded steel or forged steel.

Fittings are normally coated with a rust inhibiting paint. Other coatings including Hot Dipped Zinc Galvanizing, are available.

## Material Specifications

### Segment Welded Steel Fittings

Sizes 2" - 4" Carbon Steel pipe conforming to ASTM A53, Type "F";  
 Sizes 5" - 8"; Carbon Steel pipe conforming to ASTM A53, Type "E" or "S", Grade "B".

### Steel Fittings

Forged Steel conforming to ASTM A106.

### Adapter Flanges

Class 150 - Carbon Steel conforming to ANSI B16.5  
 Class 300 - Carbon Steel conforming to ANSI B16.5

| Fitting Size |        |
|--------------|--------|
| Nominal Size | O.D.   |
| In./DN(mm)   | In./mm |
| 2            | 2.375  |
| 50           | 60.3   |
| 2½           | 2.875  |
| 65           | 73.0   |
| 3            | 3.500  |
| 80           | 88.9   |
| 3½           | 4.000  |
| 90           | 101.6  |
| 4            | 4.500  |
| 100          | 114.3  |
| 5            | 5.563  |
| 140          | 141.3  |
| 6            | 6.625  |
| 150          | 168.3  |
| 8            | 8.625  |
| 200          | 219.1  |

### Note:

The Fitting Size Chart is used to determine the O.D. of the pipe that the fittings is to be used with. Gruvlok Fittings are identified by either the Nominal size in inches or the Pipe O.D. In./mm.



| PROJECT INFORMATION | APPROVAL STAMP    |
|---------------------|-------------------|
| Project:            | Approved          |
| Address:            | Approved as noted |
| Contractor:         | Not approved      |
| Engineer:           | Remarks:          |
| Submittal Date:     |                   |
| Notes 1:            |                   |
| Notes 2:            |                   |

**Fig. 7061P**  
Reducing Tee

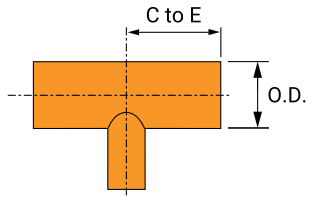

| Nominal Size                    | Center to End | Approx. Wt. Ea. |
|---------------------------------|---------------|-----------------|
| In./DN(mm)                      | In./mm        | Lbs./kg         |
| 3 x 3 x 2<br>80 x 80 x 50       | 5½<br>140     | 7.1<br>3.2      |
| 4 x 4 x 2<br>100 x 100 x 50     | 5⅞<br>149     | 11.3<br>5.1     |
| 4 x 4 x 2½<br>100 x 100 x 65    | 5⅞<br>149     | 11.6<br>5.3     |
| 4 x 4 x 3<br>100 x 100 x 80     | 5⅞<br>149     | 11.9<br>5.4     |
| 6 x 6 x 2<br>150 x 150 x 50     | 7⅞<br>194     | 24.6<br>11.2    |
| 6 x 6 x 3<br>150 x 150 x 80     | 7⅞<br>194     | 25.4<br>11.5    |
| 6 x 6 x 4<br>150 x 150 x 100    | 7⅞<br>194     | 26.2<br>11.9    |
| 8 x 8 x 2<br>200 x 200 x 50     | 10<br>254     | 42.0<br>19.1    |
| 8 x 8 x 3<br>200 x 200 x 80     | 10<br>254     | 44.0<br>20.0    |
| 8 x 8 x 4<br>200 x 200 x 100    | 10<br>254     | 46.0<br>20.9    |
| 8 x 8 x 5<br>200 x 200 x 125    | 10<br>254     | 48.0<br>21.8    |
| 8 x 8 x 6<br>200 x 200 x 150    | 10<br>254     | 50.0<br>22.7    |
| 10 x 10 x 4<br>250 x 250 x 100  | 11½<br>292    | 74.0<br>33.6    |
| 10 x 10 x 6<br>250 x 250 x 150  | 11½<br>292    | 78.0<br>35.4    |
| 10 x 10 x 8<br>250 x 250 x 200  | 11½<br>292    | 86.0<br>39.0    |
| 12 x 12 x 6<br>300 x 300 x 150  | 13½<br>343    | 112.0<br>50.8   |
| 12 x 12 x 8<br>300 x 300 x 200  | 13½<br>343    | 118.0<br>53.5   |
| 12 x 12 x 10<br>300 x 300 x 250 | 13½<br>343    | 130.0<br>59.0   |

**Fig. 7084P**  
Flange Nipples (Plain-End x Class 150)

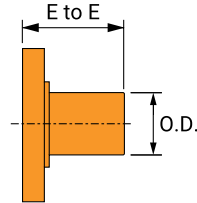

| Nominal Size | O.D.           | Center to End | Approx. Wt. Ea. |
|--------------|----------------|---------------|-----------------|
| In./DN(mm)   | In./mm         | In./mm        | Lbs./kg         |
| 2<br>50      | 2.375<br>60.3  | 4<br>102      | 6.0<br>2.7      |
| 2½<br>65     | 2.875<br>73.0  | 4<br>102      | 9.2<br>4.2      |
| 3<br>80      | 3.500<br>88.9  | 4<br>102      | 10.4<br>4.7     |
| 4<br>100     | 4.500<br>114.3 | 6<br>152      | 19.1<br>8.7     |
| 5<br>125     | 5.563<br>141.3 | 6<br>152      | 23.0<br>10.4    |
| 6<br>150     | 6.625<br>168.3 | 6<br>152      | 29.5<br>13.4    |
| 8<br>200     | 8.625<br>219.1 | 6<br>152      | 43.5<br>19.7    |

**Fig. 7085P**  
Flange Nipples (Plain-End x Class 300)

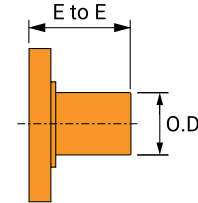

| Nominal Size | O.D.           | Center to End | Approx. Wt. Ea. |
|--------------|----------------|---------------|-----------------|
| In./DN(mm)   | In./mm         | In./mm        | Lbs./kg         |
| 2<br>50      | 2.375<br>60.3  | 4<br>102      | 8.2<br>3.7      |
| 2½<br>65     | 2.875<br>73.0  | 4<br>102      | 11.9<br>5.4     |
| 3<br>80      | 3.500<br>88.9  | 4<br>102      | 15.5<br>7.0     |
| 4<br>100     | 4.500<br>114.3 | 6<br>152      | 28.0<br>12.7    |
| 5<br>125     | 5.563<br>141.3 | 6<br>152      | 35.0<br>15.9    |
| 6<br>150     | 6.625<br>168.3 | 6<br>152      | 50.0<br>22.7    |
| 8<br>200     | 8.625<br>219.1 | 6<br>152      | 72.0<br>32.7    |



asc-es.com

Building connections that last™