

Ball-valves Series 7500



The Series 7500 grooved-end ball valve line consists of a 2" to 6", two piece design, and is available in configurations to address a broad spectrum of application requirements.

The Series 7500 has generous factors of safety for pressure retention and stem torsional strength. In addition, it has a blow-out proof stem design, low operating torque, and high Cv.

The Series 7500 is compliant with NACE MR01-75 when stainless steel trim is specified.

Grooved ends conform to the requirements of AWWA C606 for steel pipe.

For special configurations, contact your ASC Engineered Solutions representative.

For stainless steel, see the stainless steel section.

Pressure-Rating: 800 psig CWP (55 bar) in ASTM A 395 Ductile Iron

Material Specifications

Ductile Iron/Stainless Steel

Body

Ductile Iron ASTM A 395

Endplate

Ductile Iron ASTM A 395

Ball

Stainless Steel 316 or 304

Stem

316 Stainless Steel

Thrust Washer

RTFE

Stem Seal

Flouroelastomer

Retaining Ring

Carbon Steel

Handle

Carbon Steel Zinc Plated

Handle Nut

300 Series Stainless Steel

Seat

RTFE

Body Seal

Viton

Lock Plate

300 Series Stainless Steel



PROJECT INFORMATION	APPROVAL STAMP
Project:	Approved
Address:	Approved as noted
Contractor:	Not approved
Engineer:	Remarks:
Submittal Date:	
Notes 1:	
Notes 2:	

Ball-valves Series 7500

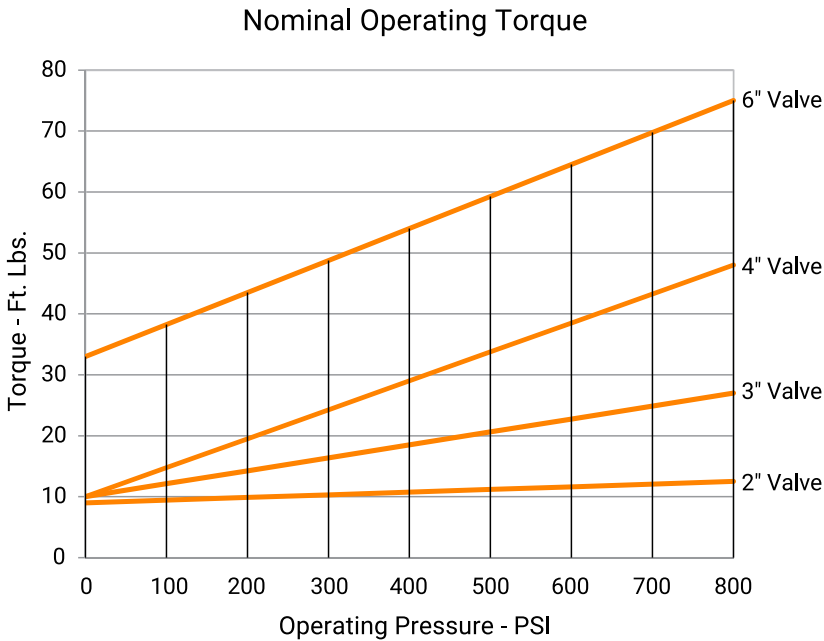

The nominal torque values are for water and lubricating service only.
 For dry gasses an additional multiplier of 2 should be applied to the nominal values.
 Additional torque of up to 3 times the nominal value may be required to break the ball loose if the valve is not frequently operated.

Series 7500 Ball Valves (Ordering Information)

Sample Part Number	4"	G	I-	75	4	2-	2
4" GI-7512-2 -->	Size	Configuration	Body/End Material	Series	Ball and Stem Material	Seat Material	Operator
	2" - 6"	G - 2 Way Grooved End	I - Ductile Iron ASTM A395	75 - 7500	4 - 304 Stainless Steel (2" - 4") 6 - 316 Stainless Steel	2 - RTFE / Fluoroelastomer	2 - 2 Position Locking Handle 3 - Bare Stem (6" only) M - Mining Handle (4" & 6" only)



asc-es.com

Building connections that last™

Ball-valves Series 7500

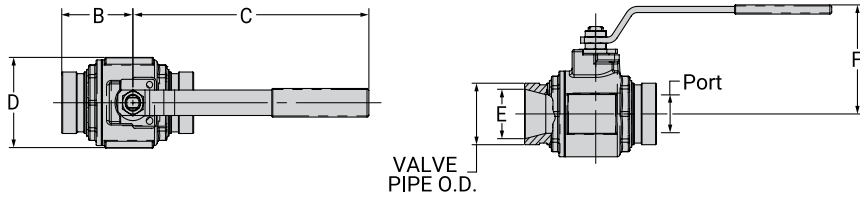

7500 Ball Valve

Size ANSI	O.D.	Nominal Dimensions							Cv	Approx. Wt. Ea.
		A	B	C	D	E	F	Port		
2 50	2.375 60.3	5½ 140	2 ³¹ / ₃₂ 75	9 ⁵⁵ / ₆₄ 250	3½ 89	1 ⁵⁹ / ₆₄ 49	4 ¹⁵ / ₆₄ 107	1½ 38	170	7.5 3.4
3 80	3.500 88.9	6 ⁹ / ₁₆ 167	3 ³⁷ / ₆₄ 91	12 ⁵ / ₈ 321	5 ⁵ / ₆₄ 129	2 ⁵⁷ / ₆₄ 74	5 ³¹ / ₆₄ 139	2½ 64	425	18.0 8.2
4 100	4.500 114.3	8¼ 210	4 ¹¹ / ₆₄ 106	15 ¹ / ₆₄ 382	5 ²⁹ / ₃₂ 150	¾ 95	5 ¹⁵ / ₁₆ 151	3 76	600	34.0 15.5
6* 150	6.625 168.3	10 ⁷ / ₆₄ 257	5 ¹ / ₁₆ 129	15 ¹ / ₆₄ 382	7 ³³ / ₆₄ 191	5 ⁶³ / ₆₄ 152	7 ¹³ / ₃₂ 188	4 102	850	67.0 30.5

* 6" sizes come bare stem only. 2 position locking handle sold separately.

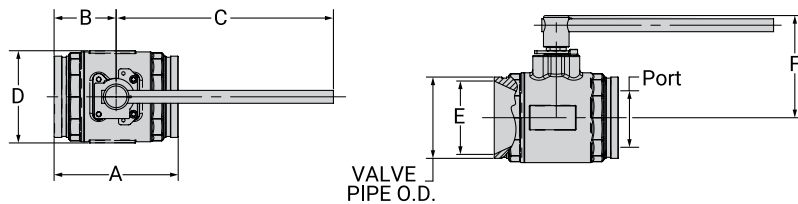

7500 Ball Valve With Mining Handle

Size ANSI	O.D.	Nominal Dimensions							Cv	Approx. Wt. Ea.
		A	B	C	D	E	F	Port		
4* 100	4.500 114.3	8¼ 210	4 ¹¹ / ₆₄ 106	17 ²³ / ₃₂ 450	5 ²⁹ / ₃₂ 150	¾ 95	6 ⁵⁵ / ₆₄ 174	3 76	600	35.0 15.9
6* 150	6.625 168.3	10 ⁷ / ₆₄ 257	5 ¹ / ₁₆ 129	17 ²³ / ₃₂ 450	7 ³³ / ₆₄ 191	5 ⁶³ / ₆₄ 152	8 ²¹ / ₆₄ 212	4 102	850	68.0 30.9

* Mining handle sold separately.



asc-es.com

Building connections that last™

Ball-valves Series 7500

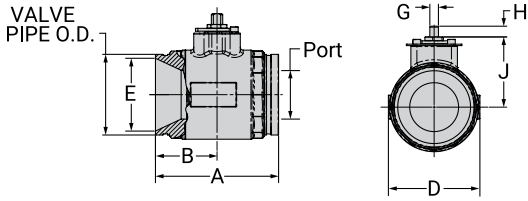

7500 Ball Valve With Bare Stem

Size ANSI	O.D.	Nominal Dimensions								Cv	Approx. Wt. Ea.
		A	B	D	E	G	H	I	Port		
In./DN(mm)	In./mm	In./mm	In./mm	In./mm	In./mm	In./mm	In./mm	In./mm	In./mm	Lbs./Kg	
6	6.625	10 ⁷ / ₆₄	5 ¹ / ₁₆	7 ³³ / ₆₄	5 ⁶³ / ₆₄	4 ⁵ / ₆₄	7 ⁷ / ₈	5 ⁴⁹ / ₆₄	4	850	66.0
150	168.3	257	129	191	152	18	23	147	102		30.0

Standard option, handle sold separately.



asc-es.com

Building connections that last™