

## 1/2" Conduit Connector Fitting Assembly Fig. AS 2560

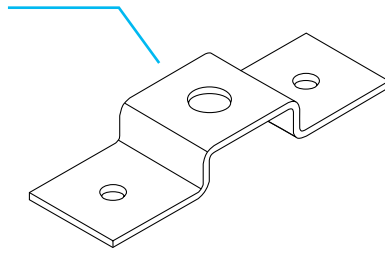

### Description

Anvil-Strut Miscellaneous Fittings are designed to fit with all Anvil-Strut 1 5/8" wide channels. Unless otherwise noted, Anvil-Strut Miscellaneous Fittings are manufactured from 1/4" thick carbon steel, 1 5/8" wide, all holes are 9/16" diameter, spaced 1 7/8" on center and 13/16" from the end.

### Conduit Connector Fitting Assembly

AS 2560 EG, 2561 EG

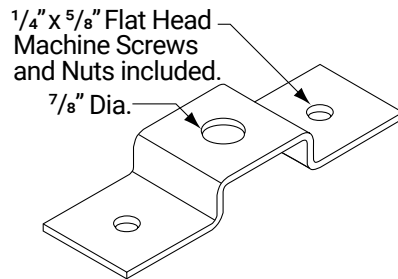

| Catalog No. | Use with     | Std. Pkg. | Wt./100 Pcs. |
|-------------|--------------|-----------|--------------|
| AS 2560     | 1/2" Conduit | 50        | 36           |
| AS 2561     | 3/4" Conduit | 25        | 36           |

Std Pkg & Wt/100 pcs: See chart above.

Page notes unless otherwise specified: 1/4" thick, 1 5/8" wide, holes 9/16" diameter, spaced 1 7/8" on center and 13/16" from end.

#### LEGEND:

**GR:** Powder Coated Supr-Green **EG:** Electro-Galvanized **PG:** Pre-Galvanized **AL:** Aluminum

**HG:** Hot Dipped Galvanized **PL:** Plain **SS:** Stainless Steel

**ZTC:** Zinc Trivalent Chromium Stainless Steel (**SS**), Zinc Trivalent Chromium (**ZTC**) and Hot Dipped Galvanized (**HG**) are specialty finishes. Pricing is located in the Specialty Strut Section of the Anvil-Strut price book.



| PROJECT INFORMATION | APPROVAL STAMP    |
|---------------------|-------------------|
| Project:            | Approved          |
| Address:            | Approved as noted |
| Contractor:         | Not approved      |
| Engineer:           | Remarks:          |
| Submittal Date:     |                   |
| Notes 1:            |                   |
| Notes 2:            |                   |