

## Cup Support for Standard Single Strut Figs. AS 677, AS 687, AS 733, AS 735

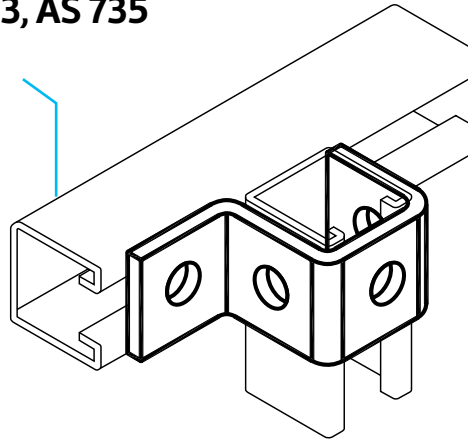

### Description

Anvil-Strut "U" Supports are designed to fit with all Anvil-Strut  $1\frac{5}{8}$ " wide channels. Unless otherwise noted, Anvil-Strut "U" Supports are manufactured from  $\frac{1}{4}$ " thick carbon steel,  $1\frac{5}{8}$ " wide, all holes are  $\frac{9}{16}$ " diameter, spaced  $1\frac{7}{8}$ " on center and  $\frac{13}{16}$ " from the end.

### 6-Hole "U" Support

AS 733 EG, GR

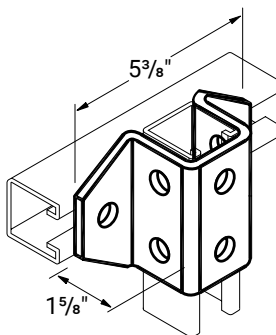

Use with AS 200 & AS 210  
Std Pkg 10 - Wt/100 pcs: 167 Lbs.

### 8-Hole "U" Support

AS 735 EG, GR

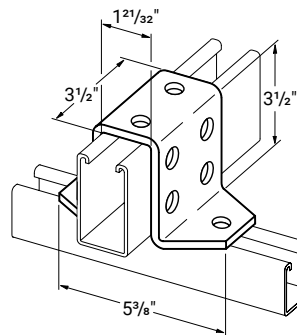

Use with AS 200 BTB  
Std Pkg 10 - Wt/100 pcs: 266 Lbs.

**Page notes unless otherwise specified:**  $\frac{1}{4}$ " thick,  $1\frac{5}{8}$ " wide, holes  $\frac{9}{16}$ " diameter, spaced  $1\frac{7}{8}$ " on center and  $\frac{13}{16}$ " from end.

#### LEGEND:

**GR:** Powder Coated Supr-Green **EG:** Electro-Galvanized **PG:** Pre-Galvanized **AL:** Aluminum  
**HG:** Hot Dipped Galvanized **PL:** Plain **SS:** Stainless Steel **ZTC:** Zinc Trivalent Chromium  
Stainless Steel (**SS**), Zinc Trivalent Chromium (**ZTC**) and Hot Dipped Galvanized (**HG**) are specialty finishes.  
Pricing is located in the Specialty Strut Section of the Anvil-Strut price book.



PROJECT INFORMATION	APPROVAL STAMP
Project:	Approved
Address:	Approved as noted
Contractor:	Not approved
Engineer:	Remarks:
Submittal Date:	
Notes 1:	
Notes 2:	

## Cup Support for Standard Single Strut Figs. AS 677, AS 687, AS 733, AS 735

### Slotted "U" Bolt

AS 687 EG, GR

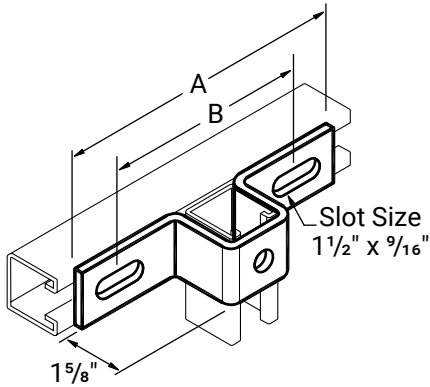

Catalog No.	A	B	Wt./100 Pcs.
AS 687 A	7 1/4"	4 1/8"	103
AS 687 B	8 1/2"	5 3/8"	115
AS 687 C	10 3/8"	7 1/4"	135

Use with AS 200 & AS 210  
Std Pkg 10 - Wt/100 pcs: See chart above.

### Cup Support for Standard Single Strut

AS 677 EG, GR

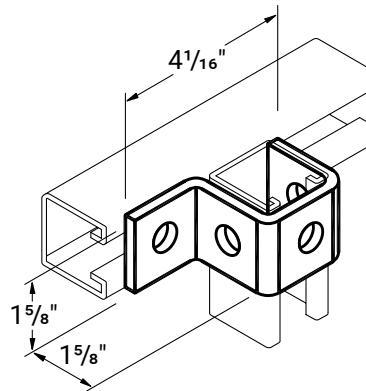

Use with AS 200 & AS 210  
Std Pkg 25 - Wt/100 pcs: 88 Lbs.

#### LEGEND:

**GR:** Powder Coated Supr-Green **EG:** Electro-Galvanized **PG:** Pre-Galvanized **AL:** Aluminum  
**HG:** Hot Dipped Galvanized **PL:** Plain **SS:** Stainless Steel **ZTC:** Zinc Trivalent Chromium  
Stainless Steel (**SS**), Zinc Trivalent Chromium (**ZTC**) and Hot Dipped Galvanized (**HG**) are specialty finishes.  
Pricing is located in the Specialty Strut Section of the Anvil-Strut price book.