

## Lightweight Flexible Coupling Fig. FP7000



 - Available galvanized



The Gruvlok Figure 7000 Lightweight Coupling is designed for applications where system flexibility is desired.

The Figure 7000 Lightweight Coupling is approximately 30% lighter in weight than the Figure 7001 Coupling. Working pressure ratings shown are for reference only and are based on Schedule 40 pipe. For the latest UL/ULC listed, LPCB, VdS and FM Approved pressure ratings versus pipe schedule, see [www.asc-es.com](http://www.asc-es.com) or contact your local ASC Engineered Solutions™ Representative.

The Figure 7000 Lightweight Coupling with a Pre-Lubricated Grade “E” EPDM, Type “A” gasket (coupling is easily identified by purple nuts) is intended for use in fire protection systems installed in accordance with NFPA Standard 13 “Sprinkler Systems”.

For Listings/Approval Details and Limitations, visit our website at [www.asc-es.com](http://www.asc-es.com) or contact an ASC Engineered Solutions™ Sales Representative.

\*When ordering, refer to product as FP7000.

## Material Specifications

### Housing

Ductile Iron conforming to ASTM A536, Grade 65-45-12

### ANSI Bolts & Heavy Hex Nuts

Heat treated, oval-neck track head bolts conforming to ASTM A183 Grade 2 with a minimum tensile strength of 110,000 psi and heavy hex nuts of carbon steel conforming to ASTM A563 Grade A or Grade B, or J995 Grade 2. Bolts and nuts are provided zinc electroplated as standard.

### Metric Bolts & Heavy Hex Nuts

Heat treated, zinc electroplated oval-neck track head bolts made of carbon steel with mechanical properties per ISO 898-1 Class 8.8. Hex nuts and bolts are zinc electroplated followed by a yellow chromate dip.

### Coatings

Rust inhibiting paint

Color: Orange (standard)

2" - 8" Hot Dipped Zinc Galvanized (optional)

Other Available Options

(Example: RAL3000 or RAL9000 Series)

For other Coating requirements contact an ASC Engineered Solutions Representative.

### Lubrication

Standard Gruvlok

Gruvlok Xtreme required for dry pipe systems and freezer applications

### Gasket Materials

Properties as designated in accordance with ASTM D2000.

**Pre-Lubricated Grade “E” EPDM**, Type A Gasket

(Violet color code)

-40°F to 150°F (Service Temperature Range)

(-40°C to 66°C)

Recommended for wet and dry (oil free air) pipe fire protection sprinkler systems. For dry pipe systems and freezer applications, Gruvlok Xtreme Lubricant is required.

**Grade “EP” EPDM** (Green and Red color code)

-40°F to 250°F (Service Temperature Range)

(-40°C to 121°C)

Recommended for water service, diluted acids, alkalies solutions, oil-free air and many other chemical services.

NOT FOR USE IN PETROLEUM APPLICATIONS.

### Gasket Type

Standard C Style

Flush Gap



PROJECT INFORMATION	APPROVAL STAMP
Project:	Approved
Address:	Approved as noted
Contractor:	Not approved
Engineer:	Remarks:
Submittal Date:	
Notes 1:	
Notes 2:	

## Lightweight Flexible Coupling Fig. FP7000

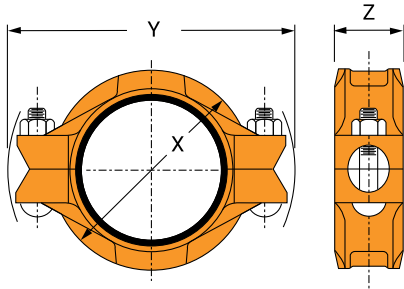

Nominal Size	Pipe O.D.	Max. Working Pressure ▲	Max. End Load	Range of Pipe End Separation	Deflection From C		Coupling Dimensions			Coupling Bolts		Specified Torque §		Approx. Wt. Ea.
					Per Coupling	Pipe	X	Y	Z	Qty.	Size	Min.	Max.	
In./DN(mm)	In./mm	PSI/bar	Lbs./kN	In./mm	Degrees	In./Ft.	In./mm	In./mm	In./mm		In./mm	Ft.-Lbs./N-m	Ft.-Lbs./N-m	Lbs./kg
1 1/4 32	1.660 42.2	500 41.4	1,299 5.78	0-1/32 0-0.79	1° 5'	0.23 18.8	2 3/4 70	4 3/8 111	1 3/4 44	2	3/8 x 2 1/4 M10 x 57	30 40	45 60	1.4 0.6
1 1/2 40	1.900 48.3	500 41.4	1,701 7.57	0-1/32 0-0.79	0° 57'	0.20 16.5	3 76	4 5/8 117	1 3/4 44	2	3/8 x 2 1/4 M10 x 57	30 40	45 60	1.5 0.7
2 50	2.375 60.3	500 41.4	2,658 11.82	0-1/32 0-0.79	0° 45'	0.16 13.1	3 1/2 89	5 1/2 140	1 3/4 44	2	3/8 x 2 1/4 M10 x 57	30 40	45 60	1.7 0.8
2 1/2 65	2.875 73.0	500 41.4	3,895 17.33	0-1/32 0-0.79	0° 37'	0.13 10.9	4 102	5 3/4 146	1 3/4 44	2	3/8 x 2 1/4 M10 x 57	30 40	45 60	1.9 0.9
3 O.D. 76.1	2.996 76.1	500 41.4	4,230 18.82	0-1/32 0-0.79	0° 36'	0.13 10.4	4 102	6 1/8 156	1 3/4 44	2	— M10 x 57	30 40	45 60	2.3 1.0
3 80	3.500 88.9	500 41.4	5,773 25.68	0-1/32 0-0.79	0° 31'	0.11 8.9	4 5/8 117	6 3/4 171	1 3/4 44	2	1/2 x 2 3/4 M12 x 70	80 110	100 150	2.9 1.3
4 100	4.250 108.0	500 41.4	8,512 37.86	0-3/32 0-2.38	1° 16'	0.26 22.0	5 1/2 140	7 3/4 197	2 51	2	1/2 x 3 M12 x 76	80 110	100 150	4.0 1.8
4 1/4 O.D. 108	4.500 114.3	500 41.4	9,543 42.45	0-3/32 0-2.38	1° 12'	0.25 20.8	5 7/8 149	8 1/8 206	2 51	2	1/2 x 3 M12 x 76	80 110	100 150	4.6 2.1
5 125	5.236 133.0	450 34.5	10,766 47.89	0-3/32 0-2.38	1° 2'	0.21 17.9	6 1/2 165	9 1/8 232	2 51	2	5/8 x 3 1/2 M16 x 85	100 135	130 175	5.7 2.6
5 1/4 O.D. 133	5.500 139.7	450 34.5	11,879 52.84	0-3/32 0-2.38	0° 59'	0.20 17.0	6 3/4 171	9 3/8 238	2 51	2	— M16 x 85	100 135	130 175	6.0 2.7

**Note:**

Not for use in copper system.

Range of Pipe End Separation and Angular Deflection values are for roll grooved pipe and may be doubled for cut groove pipe.

§ – For additional Bolt Torque information see Technical Data Section.

▲ – Working Pressure Ratings are for reference only and based on Sch. 40 pipe. For the latest UL/ULC, FM, VdS and LPCB pressure ratings versus pipe schedule, please visit [www.asc-es.com](http://www.asc-es.com) or contact your local ASC Engineered Solutions™ Representative.

Other sizes available, see Gruvlok Catalog or contact an ASC Engineered Solutions Representative.

**Warning:** For dry pipe systems and freezer applications lubrication of the gasket is required, Gruvlok Xtreme Lubricant is required.



[asc-es.com](http://asc-es.com)

Building connections that last™

## Lightweight Flexible Coupling Fig. FP7000

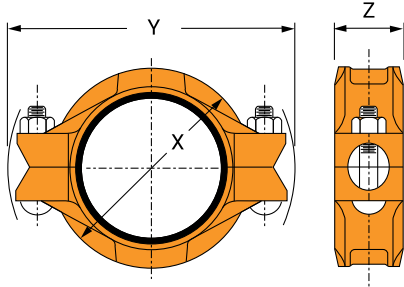

Nominal Size	Pipe O.D.	Max. Working Pressure ▲	Max. End Load	Range of Pipe End Separation	Deflection From $\zeta$		Coupling Dimensions			Coupling Bolts		Specified Torque §		Approx. Wt. Ea.
					Per Coupling	Pipe	X	Y	Z	Qty.	Size	Min.	Max.	
In./DN(mm)	In./mm	PSI/bar	Lbs./kN	In./mm	Degrees	In./ft.	In./mm	In./mm	In./mm		In./mm	Ft.-Lbs./N-m	Ft.-Lbs./N-m	Lbs./kg
5½ O.D. 139.7	5.563 141.3	450 34.5	12,153 54.06	0-¾/32 0-2.38	0° 58'	0.20 16.8	7 178	9⅝ 244	2 51	2	⅝ x 3½ M16 x 85	100 135	130 175	6.1 2.8
6 150	6.259 159.0	450 34.5	15,384 68.43	0-¾/32 0-2.38	0° 51'	0.18 14.9	7½ 191	10⅜ 264	2 51	2	⅝ x 3½ M16 x 85	100 135	130 175	6.7 3.0
6¼ O.D. 159	6.500 165.1	450 34.5	16,592 73.80	0-¾/32 0-2.38	0° 50'	0.17 14.5	7¾ 197	10¾ 273	2 51	2	— M16 x 85	100 135	130 175	7.0 3.2
6½ O.D. 165.1	6.625 168.3	450 34.5	17,236 76.67	0-¾/32 0-2.38	0° 49'	0.17 14.1	8 203	11 279	2 51	2	⅝ x 3½ M16 x 85	100 135	130 175	8.1 3.7
8 200	8.625 219.1	450 34.5	29,213 129.95	0-¾/32 0-2.38	0° 37'	0.13 10.9	10 264	13¼ 337	2⅜ 60	2	¾ x 4½ M20 x 110	130 175	180 245	14.2 6.4

**Note:**

Not for use in copper system.

Range of Pipe End Separation and Angular Deflection values are for roll grooved pipe and may be doubled for cut groove pipe.

§ – For additional Bolt Torque information see Technical Data Section.

▲ – Working Pressure Ratings are for reference only and based on Sch. 40 pipe. For the latest UL/ULC, FM, VdS and LPCB pressure ratings versus pipe schedule, please visit [www.asc-es.com](http://www.asc-es.com) or contact your local ASC Engineered Solutions™ Representative.

Other sizes available, see Gruvlok Catalog or contact an ASC Engineered Solutions Representative.

**Warning:** For dry pipe systems and freezer applications lubrication of the gasket is required, Gruvlok Xtreme Lubricant is required.



[asc-es.com](http://asc-es.com)

Building connections that last™