

## HIGH FLOW RATE 1 1/4" HOSE

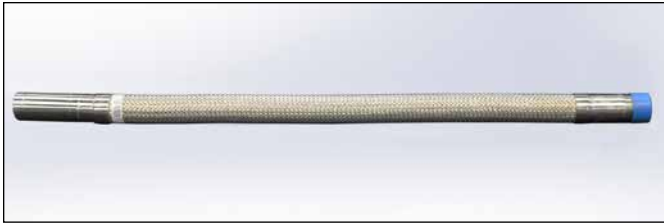

HIGH FLOW RATE HOSE: available in 36", 48", 72" hose lengths. Rated working pressure 175psi, Standard 1 1/4" I.D.

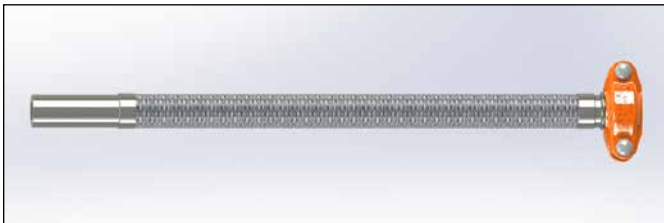

SLIDELOK® FP74 WITH SLT TECHNOLOGY

### Features and Benefits:

- FM Approved
- Best flow characteristics for flexible drops in the industry
- Great for tenant improvement projects, similar flow characteristic to 1" pipe
- All welded construction
- Factory leak tested before shipment
- FlexHead® 1.25" hose manufactured completely out of 304 corrosion resistant stainless steel
- 1 1/4 NPT Standard, 1 1/4 Cut Groove option available
- SLT option available

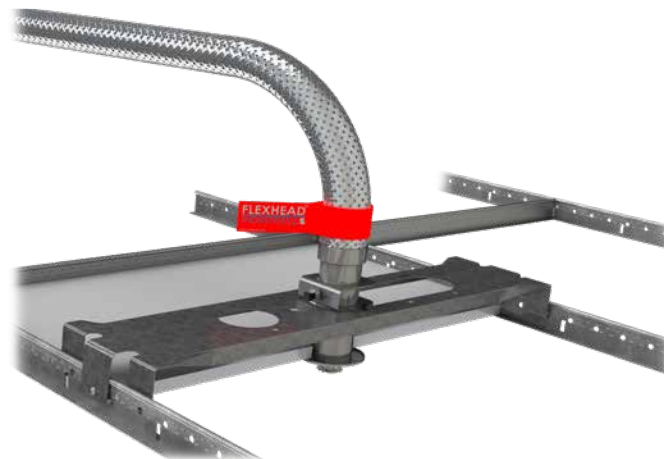

PROJECT INFORMATION		APPROVAL STAMP
Project:		<input type="checkbox"/> Approved
Address:		<input type="checkbox"/> Approved as noted
Contractor:		<input type="checkbox"/> Not approved
Engineer:		Remarks:
Submittal Date:		
Notes 1:		
Notes 2:		

## HIGH FLOW RATE 1 1/4" HOSE

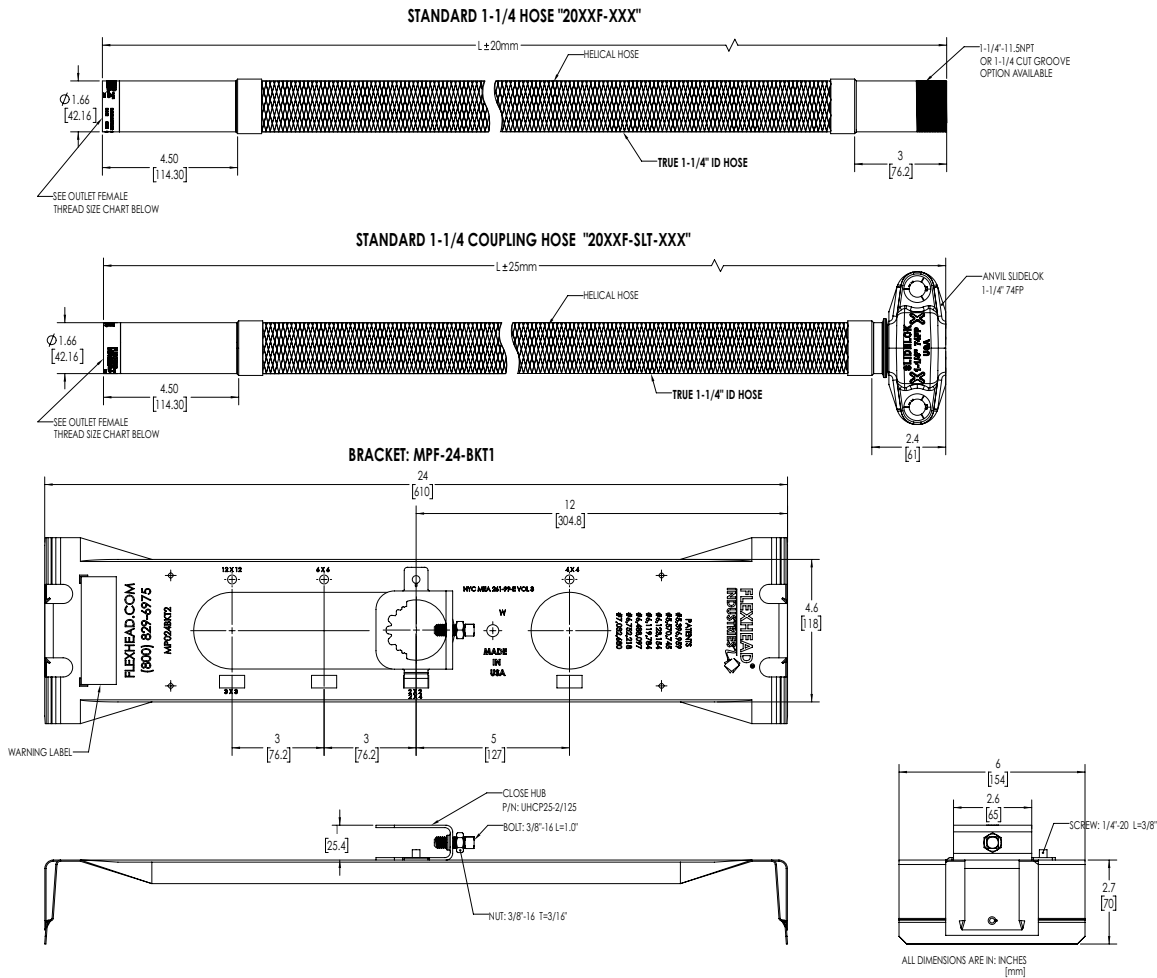

### FLEXHEAD HIGH FLOW RATE HOSE – 1 1/4" INTERNAL DIAMETER (I.D.) HOSE SERIES

Data equivalent for all end connection 1 1/4" NPT, 1 1/4" cut groove, and SLT

Model Number	Outlet Orifice Size	Hose Assembly Length (L)	Minimum Bend Radius FM	Max. Number of 90° Bends FM	Equivalent Length of 1 in. Schedule 40 Pipe (Ft.)							Max. Rated Working Pressure
					FM							
					5.6 k-Factor	8.0 k-Factor	11.2 k-Factor	14.0 k-Factor	16.8 k-Factor	22.4 k-Factor	28.0 k-Factor	
In./cm.	In./mm.	In./mm.	In./mm.	Ft./m.	Ft./m.	Ft./m.	Ft./m.	Ft./m.	Ft./m.	Ft./m.	PSI/Kpa	
2036F-50	1/2 1.27	36 914	7 180	1	4.1 1.2	4.1 1.2	4.1 1.2	—	—	—	—	175 1205
2048F-50		48 1219		2	5.4 1.6	5.6 1.7	5.7 1.7	—	—	—		
2072F-50		72 1828		4	8.0 2.4	8.6 2.6	9.1 2.7	—	—	—		
2036F-75	3/4 1.90	36 914	7 180	1	—	—	—	—	3.4 1.0	—	—	175 1205
2048F-75		48 1219		2	—	—	—	—	4.8 1.4	—	—	
2072F-75		72 1828		4	—	—	—	—	7.6 2.3	—	—	
2036F-100	1 2.54	36 914	7 180	2	—	—	—	—	—	3.4 1.0	3.3 1.0	175 1205
2048F-100		48 1219		3	—	—	—	—	—	4.8 1.5	5.4 1.6	
2072F-100		72 1828		4	—	—	—	—	—	7.6 2.3	9.4 2.9	

Model Numbers: The "F" designates high flow rate using 1 1/4" I.D. hose series. The "50" designates 1/2" Outlet Hose Series. The "75" designates 3/4" Outlet Hose Series. The "100" designates 1" Outlet Hose Series.

\*20XX-FG for cut groove option

See listing(s) approval agency for the latest approval details.

## INSTALLATION INSTRUCTIONS

### MPF24BKT1 Multi-Position F-Series Hub Bracket (MPF) Installation of FlexHead Commercial Ceiling Flexible Sprinkler Drop System

Recommend the use of proper PPE for installation. MPF24BKT2 is approved for use with the standard FlexHead® Flexible Sprinkler Hose in accordance to NFPA 13, 13D, & 13R for use in wet and dry sprinkler system. The Standard Flexible sprinkler hoses are UL approved for limited flexibility and are intended for direct sprinkler connection.

The MPF24BKT1 is pre-assembled at center tile position.  
(See below for additional installation configurations)

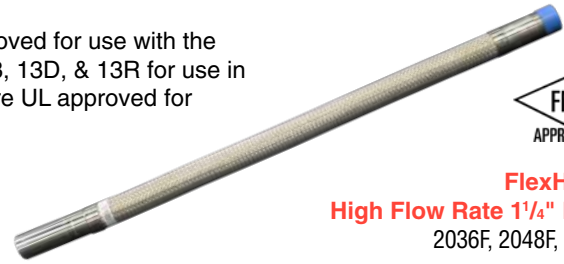

**FlexHead®**  
**High Flow Rate 1 1/4" Hose**  
2036F, 2048F, 2072F

### 1 T Bar Ceiling Grid Installation

The MPF bracket is designed for use on ceiling grids conforming to ASTM C 635\*.

Locate the center of the ceiling tile marking, align the offset screw with that marking for true center of tile installation. Insert one bracket leg at a time, applying a downward pressure on the bracket leg and T-Bar. Place the second leg on the T-Bar and repeat process. (Fig. 1)

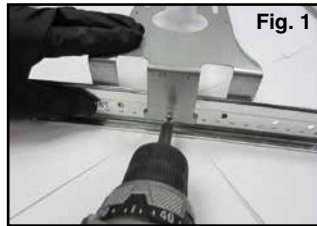

### 2 FlexHead Flexible Hose Installation

**A.** For threaded fitting branch connection: Apply Teflon® tape or pipe sealant to the 1" NPT thread. Install into branch outlet. Tighten the hose using the pipe section, never apply a wrench to the braided hose when installing.

**B.** For groove connection follow the grooved coupling manufacturer's installation instructions.

**C.** For SLT connection follow Gruvlok® installation instructions, "Fig 7074SLT SlideLOK® Ready for Installation Cap & Fitting Instructions".

The FlexHead connection can be installed in any direction from the branch. Ensure the hose is allowed at least one bend per installation to allow for seismic movement. (See fiction Loss Chart on Page 3 for details)

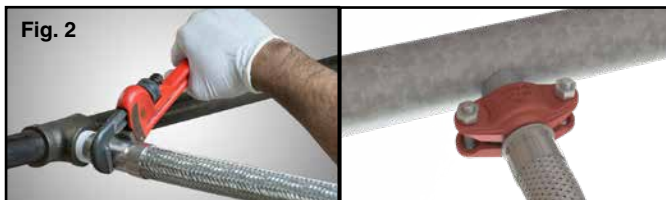

*Do not wrench on braided hose*

### 3 MPF Bracket Installation

Maneuver the flexible sprinkler drop from the branch to the MPF bracket. Review that the hose length, number of bends, and bend radius are applicable for the installation per NFPA guidelines. (See corresponding hose submittal for installation information.)

Place the 1 1/4" hose in the Hub. Ensure the drop is vertical, and the SS flexible® hose is not applying a substantial moment on the bracket causing sprinkler misalignment. Adjust the sprinkler drop for desired ceiling height.

Tighten the set screw till hand tight plus 1 turn. (100 in-lbs). Install desired sprinkler head, per the manufacturer's installation instructions.



### Installation Complete



### Installation Configurations

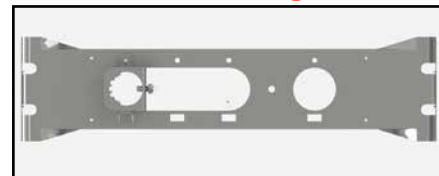

24" Tile – 24/4 - Quarter Mark Position



14 1/2" Wood Stud - Center Position ♦

U.S and International Patent Pending: #6,123,154, #6,119,784, #6,752,218, #7,032,680, #6,488,097

\*Intended for use on ASTM C 635 intermediate or heavy duty ceilings systems installed in accordance to ASTM C 636.

<b>FRICITION LOSS DATA &amp; SPECIFICATIONS</b>																	
Data equivalent for all end connection 1 1/4" NPT, 1 1/4" cut groove, and SLT																	
Model Number	Outlet Orifice Size	Hose Assembly Length	Minimum Bend Radius		Max. Number of 90° Bends			Equivalent Length of 1 in. Schedule 40 Pipe (Ft.)								Max. Rated Working Pressure	
			FM	UL	UL	FM	UL	FM								FM	UL
								5.6 k Factor	8.0 k Factor	11.2 k Factor	14.0 k Factor	16.8 k Factor	22.4 k Factor	28.0 k Factor			
	In./cm.	In./mm.	In./mm.	In./mm.	In./mm.	In./mm.	Ft./m.	Ft./m.	Ft./m.	Ft./m.	Ft./m.	Ft./m.	Ft./m.	Ft./m.	PSI/Kpa	PSI/Kpa	
2036F-50	1/2 1.27	36 914	7 180	—	—	1	—	4.1 1.2	4.1 1.2	4.1 1.2	—	—	—	—	—	175 1205	
2048F-50		48 1219				2	—	5.4 1.6	5.6 1.7	5.7 1.7	—	—	—	—			
2072F-50		72 1828				4	—	8.0 2.4	8.6 2.6	9.1 2.7	—	—	—	—			
2036F-75	3/4 1.90	36 914	7 180	—	—	1	—	—	—	—	—	3.4 1.0	—	—	—	175 1205	
2048F-75		48 1219				2	—	—	—	—	4.8 1.4	—	—	—			
2072F-75		72 1828				4	—	—	—	—	7.6 2.3	—	—	—			
2036F-100	1 2.54	36 914	7 180	—	—	2	—	—	—	—	—	3.4 1.0	3.3 1.0	—	175 1205		
2048F-100		48 1219				3	—	—	—	—	4.8 1.5	5.4 1.6	—				
2072F-100		72 1828				4	—	—	—	—	7.6 2.3	9.4 2.9	—				

**NOTES:**

- "F" designates high flow rate using 1 1/4 I.D. hose series. "SLT" designates SlideLOK Technology.
- The "50" designates 1/2" Outlet Hose Series. The "75" designates 3/4" Outlet Hose Series. The "100" designates 1" Outlet Hose Series.
- Max Ambient Temperature Rating on all model numbers are 300° F (148° C).
- Equivalent lengths are shown with maximum number of 90° bends at the minimum bend radius per agency. 2-45° or 3-30° bend equal 1-90° bend. Different values were obtained by FM and UL due to the difference in minimum bend radius, testing protocol and calculation methods. Please see individual standards for more information relative to Friction Loss (equivalent length of pipe).
- All hoses require a minimum of one bend for installation. Bend radius tool available for 3" bend "T" hose, "SF" hose does not require bend radius tool.
- FM equivalent length calculation includes Sprinkler Head Friction Loss.
- See listing(s) approval agency for the latest approval details.
- Friction loss data and specification listed for 20XXF series include all end connection such as 1 1/4" NPT, 1 1/4" cut groove, and SLT. Specify end connection when ordering.