

Building connections that last™

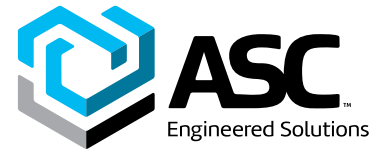

Sharpe®

Flush Bottom Tank Valves

Datasheet



Flush Bottom Tank Valves Sharpe®



High Performance
Three-Piece Ball Valve

Design & Features

Body Material

316 Stainless Steel

Tank Pad Made From Solid Bar

Machined from 316L Stainless Steel, eliminating porosity.

Three-Piece Design

In-line serviceable swing-out center section allows easy access to internal valve components without disturbing alignment of pipe.

Stem Design

Live-loaded, bottom entry, blowout proof, anti-static stem featuring packing that extends valve cycle life over conventional ball valves and is best choice for actuation.

Stem seals are live-loaded using Belleville springs to provide consistent sealing forces, reducing or eliminating the need for frequent seal adjustment.

Tongue and Groove Design

Fully encapsulated body seals, allowing ends to be welded in-line, without time consuming and labor intensive disassembly.

Design compensates for bolt expansion and reduces the chance of external leakage.

Helps prevent seal ruptures in high pressure, steam applications.

Encapsulated Body Bolts

Heavy duty stainless steel bolting is protected from outside environment assuring valve integrity.

Ideal for wash-downs.

Slotted Seat Design

Relief slots help equalize body pressure and assure leak-tight sealing. Seats also provide a wiping action that cleans ball and seats each time valve is cycled.

Design & Features Continued

Choice of Seats and Seals

A wide variety of seat and seal materials are readily available for the most demanding applications including; TFE, RTFE, TFM®, Nova, Delrin, PEEK, EPDM and Viton®

Variety of End Combinations

A wide choice of end connections are available including, but not limited to; threaded, socket weld, butt weld and flanged.

ISO 5211 Integral Mounting Pad

Ideal for actuation.

Centering lip feature assures precise alignment of bracket, stem and coupler.

Actuators may be retrofitted on existing Sharpe® Flush Bottom Tank Valves without disruption of line integrity.

Allows for secondary containment unit to be added when necessary.

Lockable Handle

All Sharpe® Flush Bottom Tank Valves are supplied with lever or pipe handles and are designed to permit locking the valve in either the open or closed position.

Traceability

Body and end piece castings are marked with heat codes providing traceability to the chemical analysis and material test reports performed at the foundry. CMTR's (Certified Material Test Reports) are available upon request.

Flush Bottom Tank Valves

Sharpe®

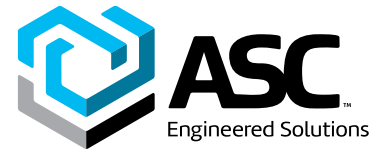

Dimensions

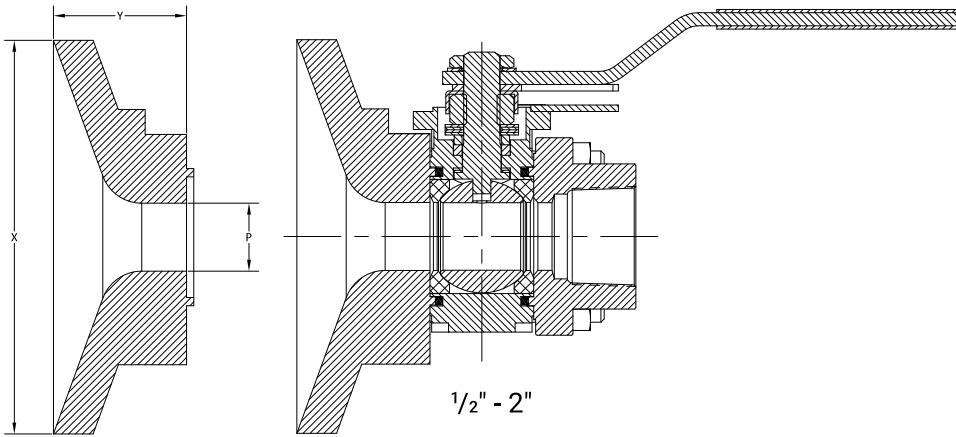

Series 84

| Size | X | Y | P |
|------|------|------|------|
| 1" | 4.75 | 1.61 | 0.82 |
| 1¼" | 4.75 | 0.79 | 1.00 |
| 1½" | 5.50 | 1.50 | 1.25 |
| 2" | 5.50 | 1.10 | 1.50 |

Series 88

| Size | X | Y | P |
|------|------|------|------|
| 1" | 3.74 | 0.79 | 0.87 |
| 1¼" | 3.74 | 0.79 | 1.12 |
| 1½" | 5.50 | 1.10 | 1.37 |
| 2" | 5.50 | 1.14 | 1.87 |

Series 99

| Size | X | Y | P |
|------|------|------|------|
| 1" | 4.75 | 0.79 | 1.00 |
| 1¼" | 5.50 | 1.50 | 1.25 |
| 1½" | 5.50 | 1.10 | 1.50 |

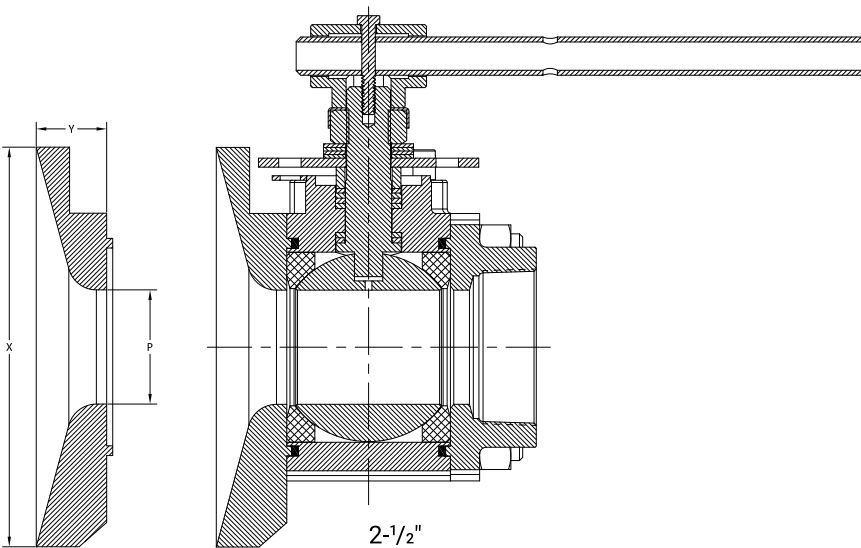

Series 84

| Size | X | Y | P |
|------|------|------|------|
| 2½" | 7.00 | 1.32 | 2.00 |

Series 88

| Size | X | Y | P |
|------|------|------|------|
| 2½" | 7.00 | 1.34 | 2.37 |

Series 99

| Size | X | Y | P |
|------|------|------|------|
| 2" | 7.00 | 1.32 | 2.00 |

Note:

The dimensions above are for information only. Please refer to Sharpe® Valves if you need dimensions for construction.

Flush Bottom Tank Valves

Sharpe®

Dimensions

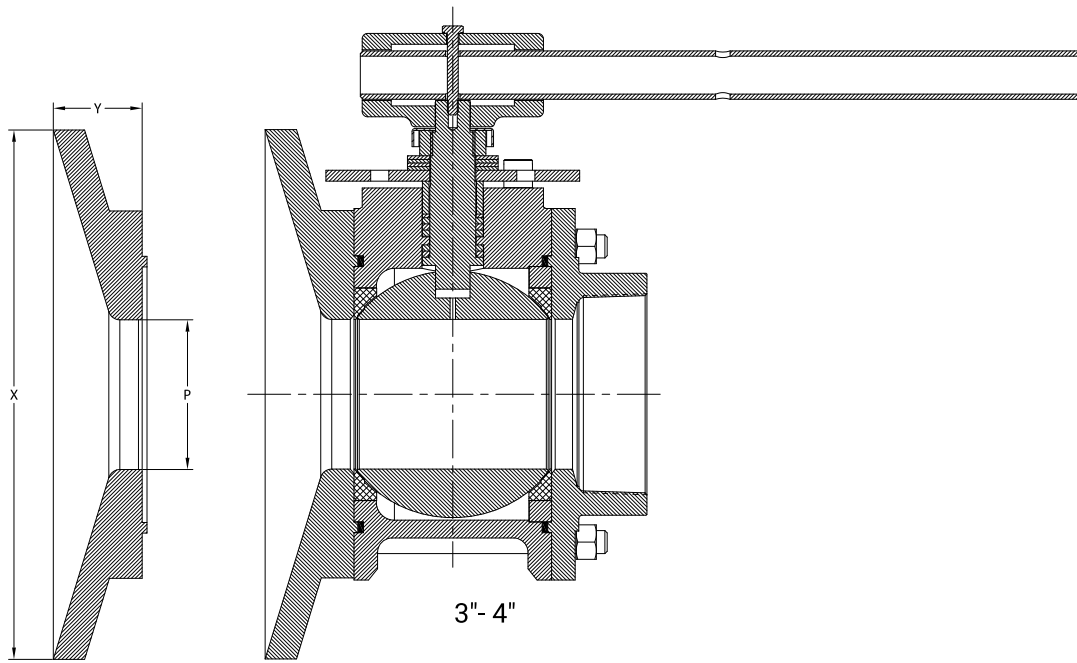

Series 84

| Size | X | Y | P |
|------|-------|------|------|
| 3" | 10.00 | 2.16 | 2.50 |
| 4" | 11.50 | 1.93 | 3.25 |

Series 88

| Size | X | Y | P |
|------|-------|------|------|
| 3" | 10.00 | 1.69 | 2.87 |
| 4" | 11.50 | 1.93 | 3.83 |

Series 99

| Size | X | Y | P |
|------|-------|------|------|
| 2½" | 10.00 | 2.16 | 2.50 |
| 3" | 11.50 | 1.93 | 3.25 |

Note:

The dimensions above are for information only. Please refer to Sharpe® Valves if you need dimensions for construction.

About ASC Engineered Solutions

ASC Engineered Solutions is defined by quality—in its products, services and support. With more than 1,400 employees, the company's portfolio of precision-engineered piping support, valves and connections provides products to more than 4,000 customers across industries, such as mechanical, industrial, fire protection, oil and gas, and commercial and residential construction. Its portfolio of leading brands includes ABZ Valve®, AFCON®, Anvil®, Anvil EPS, Anvil Services, Basic-PSA, Beck®, Catawissa, Cooplet®, FlexHead®, FPPI®, Gruvlok®, J.B. Smith, Merit®, North Alabama Pipe, Quadrant®, SCI®, Sharpe®, SlideLOK®, SPF® and SprinkFLEX®. With headquarters in Commerce, CA, and Exeter, NH, ASC also has ISO 9001:2015 certified production facilities in PA, TN, IL, TX, AL, LA, KS, and RI.



asc-es.com

Building connections that last™

FC-DS-FMTBV-v01 20211004

