

Building connections that last™

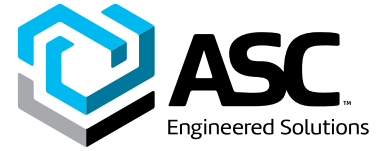

# 22B-ST QVA

2-Piece Bronze Steam Trap Test Valve  
Datasheet



# 2-Piece Bronze Steam Trap Test Valve 22B-ST QVA



### Features

- Cast Heavy Wall Bronze Bodies
- Full Port 1/4"-1" Sizes
- Standard 304SS Latch-Lock Handle
- 150 PSIG Saturated Steam Rating
- 316 Stainless Steel Ball and Stem
- Automatically exhausts "Trap Side" pressure when moved to closed position
- Allows fast and effective testing of steam trap function
- ISO 5211 Tapped Mounting Pads for mounting of actuators or extended (insulateable) handles

### Ratings

150 PSIG Saturated Steam

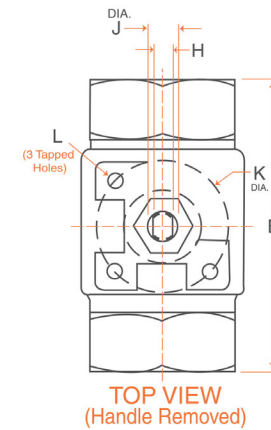
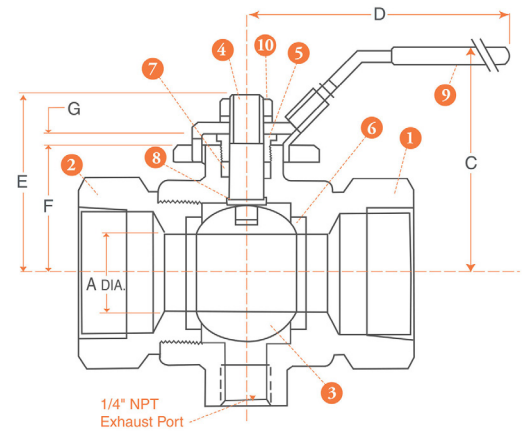

### Materials of Construction

Part	Description	Standard Material
1	Body	Bronze B584 C84400
2	Tailpiece	Brass B124 C37700
3	Ball (Vented)	ASTM A276 Gr. 316SS
4	Stem	ASTM A276 Gr. 316SS
5	Packing Nut	Brass B16 C36000
6	Seats (2)	Reinforced TFM
7	Packing	25% Carbon PTFE
8	Thrust Washer	R-PTFE
9	Handle Assy	304 Stainless Steel
10	Handle Nut	304 Stainless Steel



# 2-Piece Bronze Steam Trap Test Valve 22B-ST QVA

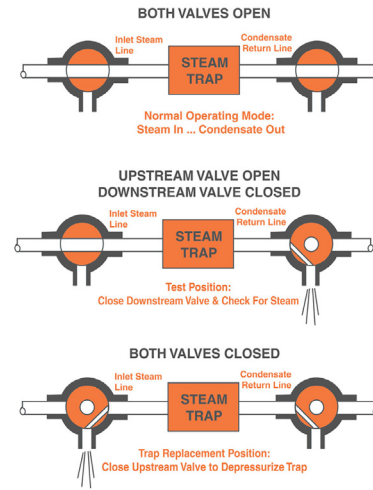
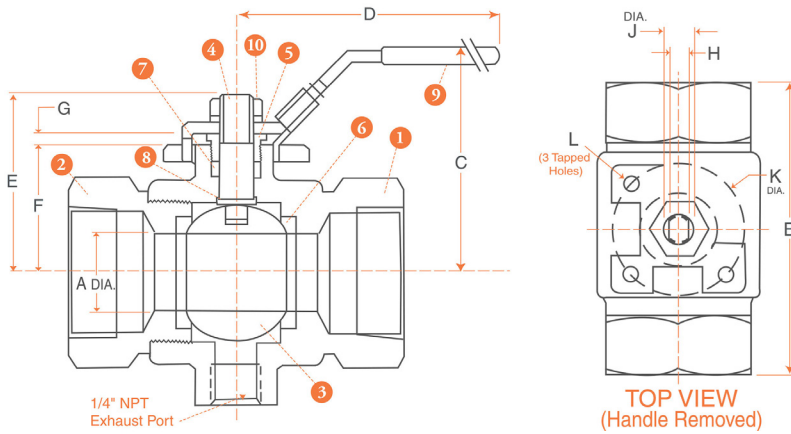

## Dimensions, Weights, Cv Factors & Maximum Operating Torque

Size	A	B	C	D	E	F	G	H	J	K DIA	L (3 TAPPED HOLES)	ISO Pattern	Weight Lbs.	CV	Max Torque (R-PTFE)
1/4 - 3/8"	0.38	2.0	1.9	4.0	1.3	0.7	0.35	0.20	0.31	1.42	1/4" -20 UNC	F03	0.7	9	60 IN-LB
1/2"	0.50	2.4	1.9	4.0	1.6	0.8	0.35	0.20	0.31	1.42	1/4" -20 UNC	F03	0.9	16	70 IN-LB
3/4"	0.75	2.9	2.2	4.8	2.1	1.0	0.43	0.28	0.44	1.65	1/4" -20 UNC	F04	2.2	35	100 IN-LB
1"	1.0	3.4	2.5	4.8	2.2	1.3	0.40	0.28	0.44	1.65	1/4" -20 UNC	F04	2.4	60	160 IN-LB
1 - 1/4"	1.0	4.0	2.7	4.8	2.6	1.4	0.45	0.35	0.56	1.97	1/4" -20 UNC	F05	2.6	52	200 IN-LB
1 - 1/2"	1.25	4.3	3.1	6.9	2.8	1.7	0.45	0.35	0.56	1.97	1/4" -20 UNC	F05	3.6	80	250 IN-LB
2"	1.5	4.6	3.3	6.9	3.1	1.9	0.47	0.35	0.56	1.97	1/4" -20 UNC	F05	5.6	115	370 IN-LB
2 - 1/2"	2.0	5.9	3.6	6.9	3.3	2.2	0.47	0.35	0.56	1.97	1/4" -20 UNC	F05	9.0	265	440 IN-LB
3"	2.5	7.1	4.5	7.9	4.1	2.8	0.49	0.41	0.75	2.76	5/16" -18 UNC	F07	16.0	420	500 IN-LB
4"	3.0	7.5	4.8	7.9	4.4	3.1	0.49	0.47	0.75	2.76	5/16" -18 UNC	F07	17.0	500	580 IN-LB

# 2-Piece Bronze Steam Trap Test Valve

## 22B-ST QVA

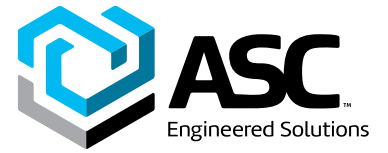

### Numbering System How to order 22B-ST QVA

<b>22</b>	<b>F</b>	<b>B</b>	<b>S</b>	<b>R</b>	<b>R</b>	<b>SL</b>	<b>TT</b>	<b>050-ST</b>
Series	Port Size	Body Material	Ball/Stem Material	Seat Material	Seal Material	Handle Type	Ends	Size
22 2 Piece	F Full (1/4"-1")	B Bronze	S 316 Stainless	R TFM (R-PTFE)	R 25% Carbon Filled PTFE	SL Stainless Latch Lock	TT FNPT	050 1/2"
	R Reduced (1- 1/4" - 2")			P PEEK		TH Tee Handle	MT MxF NPT	075 3/4"
						LO Locking Stainless Oval		100 1"
						XH Extended Handle		125 1 - 1/4"
								150 1 - 1/2"
								200 2"

### **About ASC Engineered Solutions**

ASC Engineered Solutions is defined by quality—in its products, services and support. With more than 1,400 employees, the company's portfolio of precision-engineered piping support, valves and connections provides products to more than 4,000 customers across industries, such as mechanical, industrial, fire protection, oil and gas, and commercial and residential construction. Its portfolio of leading brands includes ABZ Valve®, AFCON®, Anvil®, Anvil EPS, Anvil Services, Basic-PSA, Beck®, Catawissa, Cooplet®, FlexHead®, FPPI®, Gruvlok®, J.B. Smith, Merit®, North Alabama Pipe, Quadrant®, SCI®, Sharpe®, SlideLOK®, SPF® and SprinkFLEX®. With headquarters in Commerce, CA, and Exeter, NH, ASC also has ISO 9001:2015 certified production facilities in PA, TN, IL, TX, AL, LA, KS, and RI.



[asc-es.com](http://asc-es.com)

Building connections that last™

FC-DS-22B-ST QVA-v01 20210604

