

Building connections that last™



# SCI® Cast Iron Threaded Fittings





# Cast Iron Threaded Fittings

## Specifications

-  branded cast iron threaded fittings are UL Listed and FM Approved at 300psi
- Rated to 125 WSP
- Casting date on each fitting
- Grey iron castings conform to ASTM A126
- Cast iron fitting dimensions conform to ASME B16.4 Class 125
- NPT threads on fittings conform to ASME B1.20.1
- Cast iron fittings have SCI Trademark and are 100% air tested
- Manufacturing facility is ISO 9001:2008 and ISO 14001
- ProPak™ Packaging



**SCI ProPak™ System**

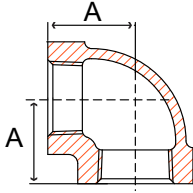

**Fig. 37E 1 – 90° Elbow**

Size in	Part Number	A in	Packing		Weight lb
			Inner	Master	
1/2	37E 1004	1.13	90	180	0.3
3/4	37E 1006	1.31	50	100	0.5
1	37E 1010	1.50	35	70	0.8
1-1/4	37E 1012	1.75	20	40	1.3
1-1/2	37E 1014	1.94	15	30	1.7
2	37E 1020	2.25	7	14	2.7
2-1/2	37E 1024	2.70	4	8	4.3

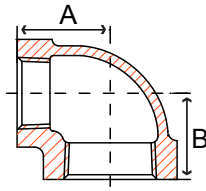

**Fig. 37RE1 – 90° Reducing Elbow**

Size in	Part Number	A in	B in	Packing		Weight lb
				Inner	Master	
1 x 1/2	37RE1010004	1.36	1.26	50	100	0.5
1 x 3/4	37RE1010006	1.45	1.38	40	80	0.7
1-1/4 x 1/2	37RE1012004	1.53	1.34	32	64	0.8
1-1/4 x 3/4	37RE1012006	1.63	1.45	28	56	0.9
1-1/4 x 1	37RE1012010	1.67	1.58	25	50	1.0
1-1/2 x 1/2	37RE1014004	1.75	1.52	25	50	1.0
1-1/2 x 3/4	37RE1014006	1.75	1.52	20	40	1.1
1-1/2 x 1	37RE1014010	1.80	1.65	18	36	1.3
1-1/2 x 1-1/4	37RE1014012	1.88	1.82	14	28	1.5
2 x 1/2	37RE1020004	1.97	1.60	15	30	1.4
2 x 3/4	37RE1020006	1.97	1.60	15	30	1.6
2 x 1	37RE1020010	2.02	1.73	12	24	1.8
2 x 1-1/2	37RE1020014	2.16	2.02	10	20	2.3

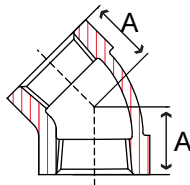

**Fig. 37F 1 – 45° Elbow**

Size in	Part Number	A in	Packing		Weight lb
			Inner	Master	
1	37F 1010	1.26	40	80	0.7
1-1/4	37F 1012	1.29	22	44	1.2
1-1/2	37F 1014	1.44	16	32	1.5
2	37F 1020	1.69	8	16	2.6

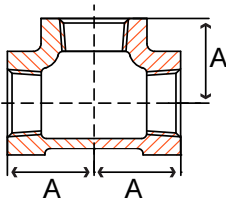

**Fig. 37T 1 – Tee**

Size in	Part Number	A in	Packing		Weight lb
			Inner	Master	
1/2	37T 1004	1.13	60	120	0.4
3/4	37T 1006	1.31	30	60	0.7
1	37T 1010	1.50	20	40	1.1
1-1/4	37T 1012	1.75	12	24	1.8
1-1/2	37T 1014	1.94	8	16	2.4
2	37T 1020	2.25	5	10	3.8

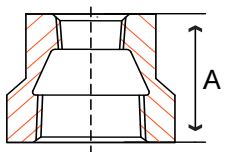

**Fig. 37RC1 – Hex Coupling**

Size in	Part Number	A in	Packing		Weight lb
			Inner	Master	
1 x 1/2	37RC1010004	1.69	60	120	0.5
1 x 3/4	37RC1010006	1.69	50	100	0.6
2 x 1 (not hex)	37RC1020010	2.81	16	32	1.5

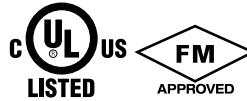

**Fig. 37RT1 – Reducing Tee**

Size in	Part Number	A in	B in	C in	Packing		Weight lb
					Inner	Master	
1 x 1/2	37RT1010004	1.26	1.26	1.36	25	50	0.9
1 x 1/2 x 1	37RT1010004010	1.50	1.36	1.50	24	48	0.9
1 x 3/4	37RT1010006	1.38	1.38	1.45	22	44	1.0
1 x 3/4 x 1	37RT1010006010	1.50	1.45	1.50	20	40	1.0
1 x 1-1/4	37RT1010012	1.67	1.67	1.58	15	30	1.4
1-1/4 x 1/2	37RT1012004	1.34	1.34	1.53	18	36	1.3
1-1/4 x 1/2 x 1-1/4	37RT1012004012	1.75	1.53	1.75	18	36	1.4
1-1/4 x 3/4	37RT1012006	1.45	1.45	1.62	15	30	1.4
1-1/4 x 3/4 x 1-1/4	37RT1012006012	1.75	1.62	1.75	15	30	1.5
1-1/4 x 1	37RT1012010	1.58	1.58	1.67	15	30	1.6
1-1/4 x 1 x 1/2	37RT1012010004	1.34	1.26	1.53	20	40	1.1
1-1/4 x 1 x 3/4	37RT1012010006	1.45	1.38	1.63	16	32	1.2
1-1/4 x 1 x 1	37RT1012010010	1.58	1.50	1.69	15	30	1.4
1-1/4 x 1 x 1-1/4	37RT1012010012	1.75	1.69	1.75	12	24	1.6
1-1/4 x 1 x 1-1/2	37RT1012010014	1.88	1.80	1.82	12	24	1.8
1-1/4 x 1-1/2	37RT1012014	1.88	1.88	1.82	10	20	2.0
1-1/2 x 1/2	37RT1014004	1.41	1.41	1.66	12	24	1.6
1-1/2 x 1/2 x 1-1/4	37RT1014004012	1.81	1.56	1.88	12	24	1.7
1-1/2 x 1/2 x 1-1/2	37RT1014004014	1.94	1.66	1.94	12	24	1.8
1-1/2 x 3/4	37RT1014006	1.52	1.52	1.75	12	24	1.8
1-1/2 x 3/4 x 1-1/4	37RT1014006012	1.94	1.66	1.88	12	24	1.7
1-1/2 x 3/4 x 1-1/2	37RT1014006014	1.94	1.75	1.94	12	24	1.9
1-1/2 x 1	37RT1014010	1.65	1.65	1.80	10	20	1.9
1-1/2 x 1 x 1/2	37RT1014010004	1.44	1.25	1.69	18	36	1.3
1-1/2 x 1 x 3/4	37RT1014010006	1.50	1.44	1.75	15	30	1.4
1-1/2 x 1 x 1	37RT1014010010	1.65	1.50	1.80	12	24	1.6
1-1/2 x 1 x 1-1/4	37RT1014010012	1.82	1.67	1.88	10	20	1.8
1-1/2 x 1 x 1-1/2	37RT1014010014	1.94	1.80	1.94	8	16	2.1
1-1/2 x 1-1/4	37RT1014012	1.82	1.82	1.88	8	16	2.2
1-1/2 x 1-1/4 x 1/2	37RT1014012004	1.41	1.34	1.66	15	30	1.5
1-1/2 x 1-1/4 x 3/4	37RT1014012006	1.52	1.45	1.75	12	24	1.6
1-1/2 x 1-1/4 x 1	37RT1014012010	1.65	1.58	1.80	12	24	1.8
1-1/2 x 1-1/4 x 1-1/4	37RT1014012012	1.82	1.75	1.88	10	20	2.1
1-1/2 x 1-1/4 x 1-1/2	37RT1014012014	1.94	1.88	1.94	8	16	2.3
1-1/2 x 1-1/4 x 2	37RT1014012020	2.16	2.10	2.02	6	12	2.7
1-1/2 x 2	37RT1014020	2.16	2.16	2.02	5	10	2.9
2 x 1/2	37RT1020004	1.49	1.49	1.88	8	16	2.6
2 x 3/4	37RT1020006	1.60	1.60	1.97	8	16	2.6
2 x 1	37RT1020010	1.73	1.73	2.02	6	12	2.9
2 x 1 x 2	37RT1020010020	2.25	2.02	2.25	5	10	3.1
2 x 1-1/4	37RT1020012	1.90	1.90	2.10	5	10	3.2
2 x 1-1/4 x 2	37RT1020012020	2.25	2.10	2.25	5	10	3.2
2 x 1-1/2	37RT1020014	2.02	2.02	2.16	5	10	3.3
2 x 1-1/2 x 1/2	37RT1020014004	1.49	1.41	1.88	8	16	2.1
2 x 1-1/2 x 3/4	37RT1020014006	1.60	1.52	1.97	8	16	2.2
2 x 1-1/2 x 1	37RT1020014010	1.73	1.65	2.02	8	16	2.4
2 x 1-1/2 x 1-1/4	37RT1020014012	1.90	1.82	2.10	7	14	2.7
2 x 1-1/2 x 1-1/2	37RT1020014014	2.02	1.94	2.16	7	14	2.9
2 x 1-1/2 x 2	37RT1020014020	2.25	2.16	2.25	5	10	3.4
2 x 2-1/2	37RT1020024	2.60	2.60	2.39	3	6	4.6

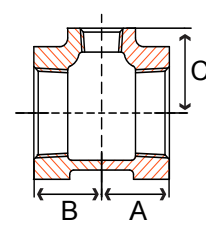

### **About ASC Engineered Solutions**

ASC Engineered Solutions is defined by quality—in its products, services and support. With more than 1,400 employees, the company’s portfolio of precision-engineered piping support, valves and connections provides products to more than 4,000 customers across industries, such as mechanical, industrial, fire protection, oil and gas, and commercial and residential construction. Its portfolio of leading brands includes ABZ Valve®, AFCON®, Anvil®, Anvil EPS, Anvil Services, Basic-PSA, Beck®, Catawissa, Cooplet®, FlexHead®, FPPI®, Gruvlok®, J.B. Smith, Merit®, North Alabama Pipe, Quadrant®, SCI®, Sharpe®, SlideLOK®, SPF® and SprinkFLEX®. With headquarters in Commerce, CA, and Exeter, NH, ASC also has ISO 9001:2015 certified production facilities in PA, TN, IL, TX, AL, LA, KS, and RI.



[asc-es.com](http://asc-es.com)

Building connections that last™

