

SCI® Press–Carbon Dimensional Reference Comparison

Fig. SP704 Coupling

	Size	ASC	Viega	Nibco	Mueller
L	½"	2.83	2.70	2.81	
	¾"	3.23	2.94	3.09	
	1"	3.58	3.26	3.36	
	1¼"	4.72	4.34	4.46	
	1½"	4.88	4.63	4.74	
	2"	5.12	4.71	4.86	
	2½"	4.92	4.92		
	3"	5.98	5.98		
	4"	7.87	7.87		
	A	½"	0.79	2.00	0.61
¾"		0.87	0.63	0.80	0.54
1"		0.87	0.57	0.61	0.59
1¼"		1.13	0.70	0.76	0.62
1½"		1.18	0.89	0.88	0.67
2"		1.26	0.77	0.84	0.84
2½"		1.06	1.32		
3"		1.38	1.38		
4"		1.61	1.57		

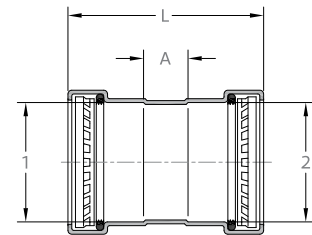
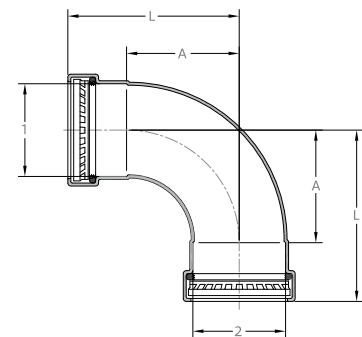

Fig. SP790 90° Elbow

	Size	ASC	Viega	Nibco	Mueller
L	½"	2.58	2.24	2.30	
	¾"	3.01	2.52	2.54	
	1"	3.56	3.07	3.13	
	1¼"	4.47	3.82	3.86	
	1½"	4.78	4.13	4.20	
	2"	5.59	4.76	4.81	
	2½"	5.98	5.94		
	3"	7.09	7.09		
	4"	9.25	9.17		
	A	½"	1.56	1.17	1.20
¾"		1.83	1.36	1.40	1.37
1"		2.20	1.72	1.75	1.96
1¼"		2.67	2.00	2.01	2.28
1½"		2.93	2.26	2.27	2.55
2"		3.66	2.80	2.81	2.93
2½"		4.06	4.15		
3"		4.78	4.76		
4"		6.12	6.00		



SCI® Press–Carbon Dimensional Reference Comparison

Fig. SP720 Tees

	Size	ASC	Viega	Nibco	Mueller
L1 & L2	½"	1.91	2.04	2.10	
	¾"	2.20	2.26	2.29	
	1"	2.54	2.57	2.63	
	1¼"	3.29	3.23	3.27	
	1½"	3.46	3.44	3.51	
	2"	3.86	3.78	3.83	
	2½"	3.90	3.98		
	3"	4.74	4.88		
	4"	6.18	6.40		
L3	½"	1.91	2.00	2.06	
	¾"	2.20	2.24	2.27	
	1"	2.54	2.57	2.63	
	1¼"	3.29	3.20	3.24	
	1½"	3.46	3.41	2.57	
	2"	3.86	3.77	3.81	
	2½"	3.90	4.06		
	3"	4.74	4.82		
	4"	6.18	6.26		
A1 & A2	½"	0.89	0.97	1.00	0.93
	¾"	1.02	1.11	1.15	1.06
	1"	1.18	1.23	1.26	1.22
	1¼"	1.49	1.41	1.42	1.40
	1½"	1.61	1.57	1.58	1.53
	2"	1.93	1.81	1.82	1.8
	2½"	1.97	2.16		
	3"	2.44	2.55		
	4"	3.05	3.22		
A3	½"	0.89	0.93	0.96	0.87
	¾"	1.02	1.09	1.13	0.98
	1"	1.18	1.23	1.26	1.18
	1¼"	1.49	1.38	1.39	1.39
	1½"	1.61	1.54	1.47	1.54
	2"	1.93	1.8	1.81	1.87
	2½"	1.97	2.26		
	3"	2.44	2.52		
	4"	3.05	3.08		

