

## 90° Short Pattern Elbow Fig. SE-1



### Material Specifications

#### Cast Fittings

Ductile Iron conforming to ASTM A536, Grade 65-45-12

#### Coatings

Rust inhibiting paint

Color: Orange (standard)

Hot Dipped Zinc Galvanized conforming to ASTM A153 (optional)

Other available options

Example: RAL3000 or RAL9000 Series



LPS 1219: Issue 3.1  
Cert/LPCB ref. 519a/20

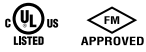

SE-1 are short pattern products and are specifically designed for use in Fire Protection applications where economy is a factor. All products are UL/ULC Listed, LPCB, VdS and FM Approved.

Maximum working pressure for these products is 300 PSI. For the latest UL/ULC listed, LPCB, VdS and FM Approved pressure ratings versus pipe schedule, see [www.asc-es.com](http://www.asc-es.com) or contact your local ASC Engineered Solutions™ Representative.

For Listings/Approval Details and Limitations, visit our website at [www.asc-es.com](http://www.asc-es.com) or contact an ASC Engineered Solutions™ Sales Representative.



PROJECT INFORMATION	APPROVAL STAMP
Project:	Approved
Address:	Approved as noted
Contractor:	Not approved
Engineer:	Remarks:
Submittal Date:	
Notes 1:	
Notes 2:	

## 90° Short Pattern Elbow Fig. SE-1

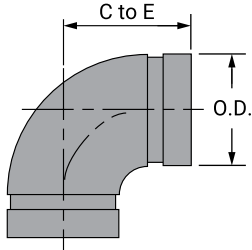

Nominal Size	O.D.	Center to End	Approx. Wt. Ea.
In./DN(mm)	In./mm	In./mm	Lbs./kg
2	2.375	2¾	1.5
50	60.3	70	0.7
2½	2.875	3	2.1
65	73.0	76	1.0
3	3.500	3¾	3.6
80	88.9	86	1.6
4	4.500	4	5.8
100	114.3	102	2.6
6	6.625	5½	11.8
150	168.3	140	5.3
8	8.625	6¾	21.1
200	219.1	175	9.6

**Note:**

Additional sizes available, contact an ASC Engineered Solutions™ Representative.

SE-1 90° Elbow Short Pattern Fitting - Pressure Drop

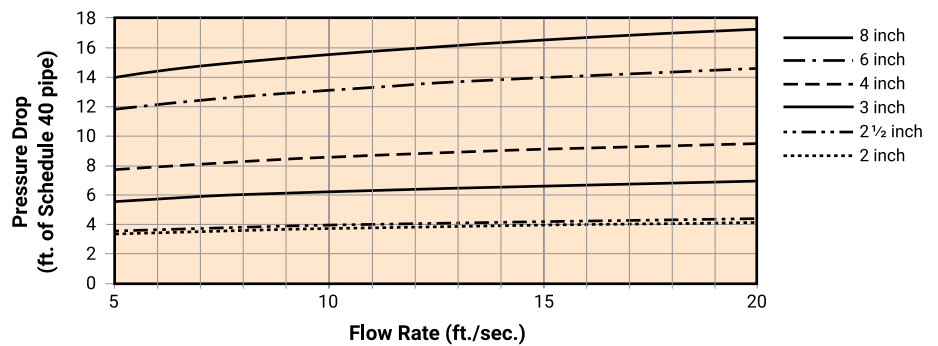

**Note:**

SPF/Anvil® short pattern fittings exceed the headloss requirements of NFPA 13.

For Fig. SE-1 90° grooved end elbows use the value shown.

Above values are shown for Schedule 40 pipe to be consistent with industry practices.



asc-es.com

Building connections that last™